

TORNADO SHELTER

2nd Floor-Old Building

Ellsworth

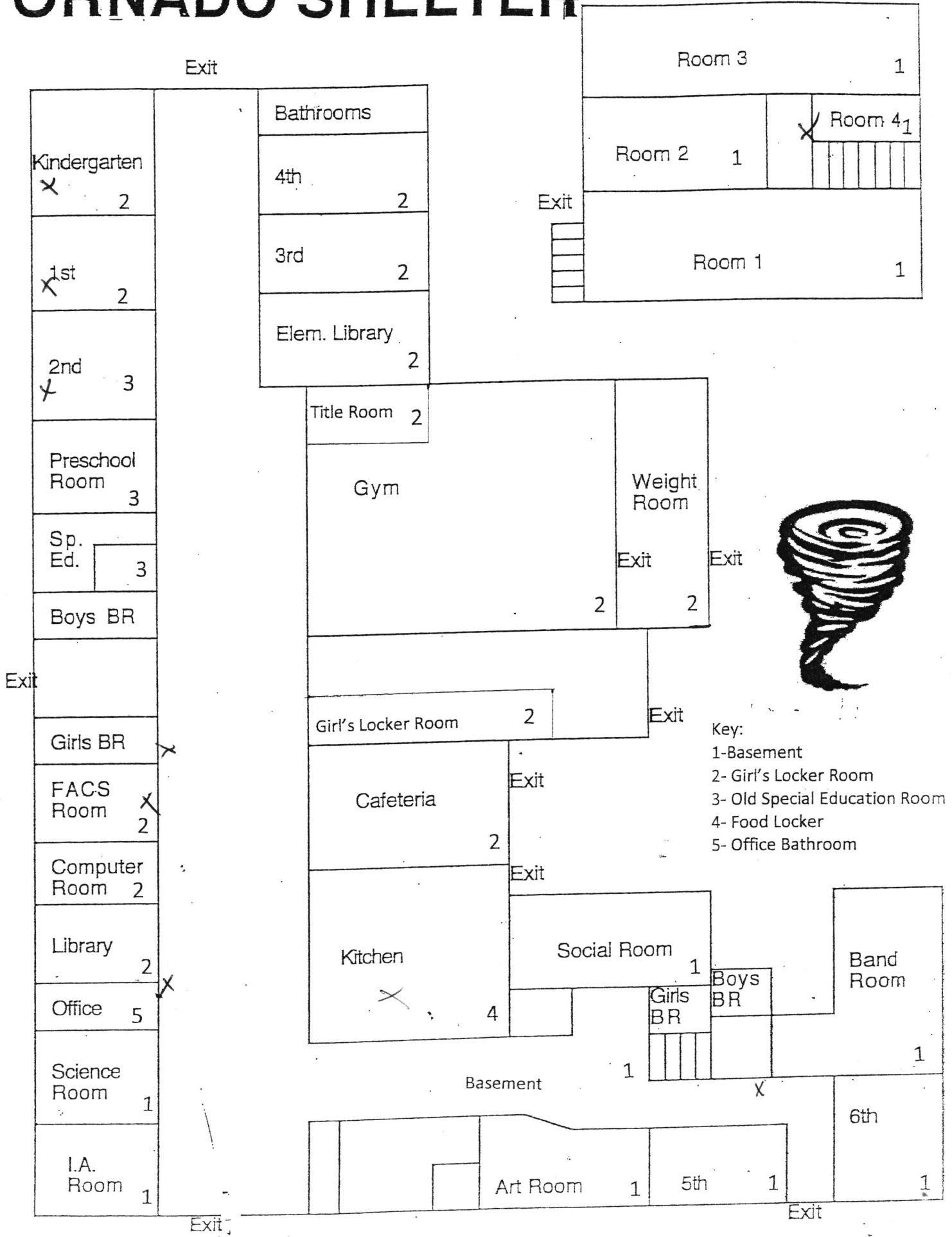

Twin City Water Clinic
 617 13th Ave South
 Hopkins, MN 55343
 (952) 935-3556 FAX (952) 935-5077

Ellsworth

CHAIN-OF-CUSTODY RECORD

Client: Advanced Health Safety & Security Client Address: 105 Third Street Balaton, MN 56115 Customer Phone No: Brian Parrie 605-430-8842	Contract Lab Information Ship To: Ship Date: Courier:
--	--

Lab ID # Lab use only	Date	Time	Sample ID	Sample Location	Lead	Sample by
	1/30/18	2:01	001	Kindergarten Rm	X	BP
	1/30/18	2:04	002	4th Grade 1st Grade Rm	X	BP
	1/30/18	2:06	003	2nd Grade Rm	X	BP
	1/30/18	2:14	004	Kitchen Exposed	X	BP
	1/30/18	2:11	005	Gym Hall 4	X	BP
	1/30/18	2:09	006	Office Hall WF	X	BP
	1/30/18	2:12	007	old Addition main floor WF	X	BP
	1/30/18	2:19	008	Systems WF	X	BP
	1/30/18	2:21	009	Home EC	X	BP

Relinquished By:	Date	Time	Relinquish To:	Date	Time

Container Intact	Yes	No	Correct Container	Yes	No	Comments:
Cooled	Yes	No	Temperature Blank	Yes	No	(°C)

Field of testing: Lead SM3113B
 TCWC Rev. 1.0a

Twin City Water Clinic Laboratory Test Report

Minnesota State Laboratory ID# 027-053-119
 Wisconsin State Laboratory ID# 105-10117
 Wisconsin DNR Lab ID #399073400

Client: Ellsworth School
 Advanced Health safety & Security
Address: 105 Third Street
 Balaton, MN 56115

Report Number: 18-01866
Sample Receipt Date: 2/2/18
Sample Prep. Date: 2/2/18
Sample Prep. Time: 12:00
Report Issue Date: 03/05/18

Twin City Water Clinic Inc.
 617 13th Avenue South
 Hopkins, MN 55343
Phone: (952)935-3556
Fax: (952)935-5077

X No samples were subcontracted; or the above test result(s) with '**' designation were produced by a subcontracted laboratory. [Laboratory name; address; MDH Lab ID#]. The subcontracted laboratory maintains MDH Certification for the field(s) of testing performed.

Laboratory Sample ID	Analyte	Sample Location	Parameter	Sample Collection		Sample Analysis		Test	
				Date	Time	Date	Time	Results	Units
18-01866	Lead	Kindergarten RM	Drinking Water	01/30/18	14:01	02/22/18	12:09	<2.0	µg/L
18-01867	Lead	1st Grade RM	Drinking Water	01/30/18	14:04	02/22/18	12:14	3.10	µg/L
18-01868	Lead	2nd Grade RM	Drinking Water	01/30/18	14:06	02/22/18	12:19	15.05	µg/L
18-01869	Lead	Kitchen Eyewash	Drinking Water	01/30/18	14:14	02/22/18	12:35	3.84	µg/L
18-01870	Lead	Gym Hall WF	Drinking Water	01/30/18	14:11	02/22/18	12:51	<2.0	µg/L
18-01871	Lead	Office Hall WF	Drinking Water	01/30/18	14:09	02/22/18	12:56	2.96	µg/L
18-01872	Lead	Old Add. Main Floor WF	Drinking Water	01/30/18	14:17	02/22/18	13:01	<2.0	µg/L
18-01873	Lead	Visitors WF	Drinking Water	01/30/18	14:19	02/22/18	13:06	2.41	µg/L
18-01874	Lead	Home EC	Drinking Water	01/30/18	14:21	02/22/18	13:11	9.38	µg/L

Approved methods used in analyzing the samples listed above have the following reporting levels:
 SM3113 - Lead, 2.0 µg / L
 Maximum contaminant level: Lead, 15.0 µg / L

Sample Collected by: X Client TCWC

Sample Temp.: 4 °C

Notes: ..

Discussion:

Approved By:

 Bill Van Arsdale
 Laboratory Manager

The results listed in this report apply only to the above listed samples. All routine quality assurance procedures were followed, unless otherwise noted. This analytical report must be reported in its entirety. All methods are certified by the Minnesota Department of Health, unless otherwise noted.